

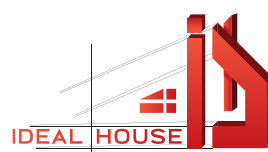

Front Doors

RD67



**LET'S MAKE
YOUR HOUSE A HOME**

The front door is a key element of the house façade. Every day you see, you touch, and use it. Consequently, the door must be:

- safe;
- energy saving;
- matching the exterior;
- maintenance-free;
- have a good appearance.

We offer a wide range of made-to-measure front doors with numerous design choices including the possibility to create your individual design.

The latest technologies combined with the perfect design result in outstanding appearance and performance.

In this brochure, You can review basic door models, designs, and options.



Designs	4
Features	22
Colours	25
Side & Top Elements	26
Handles	28
Accessories	29
Locking Systems	30
Standard Designs	32





Design **100**
Outside colour **RAL7030**
Handle **H45R-800**
Escutcheon **ESC-2**
Glazing **Etched effect**



Design **108***
Outside colour **RAL8017**
Handle **H45S-800**
Escutcheon **ESC-1**
Applique **Stainless metal**
Glazing **Clear SGC**
*Custom



Design **104**
Outside colour **RAL9005**
Handle **H45R-500**
Escutcheon **ESC-2**
Applique **Stainless metal**

Matching Design





Design **110**
Outside colour **RAL9005**
Handle **H45R-500**
Escutcheon **ESC-2**
Glazing **Etched effect**
Applique **Stainless metal**



Design **112**
Outside colour **RAL7016**
Handle **H45R-800**
Escutcheon **ESC-2**
Glazing **Etched effect**
Applique **Stainless metal**



Design **102**
Outside colour **RAL9016**
Handle **H45R-500**
Escutcheon **ESC-2**
Applique **Stainless metal**



Design **112**
Outside colour **RAL9016**
Handle **H45R-800**
Escutcheon **ESC-1**
Glazing **Clear SGC**
Applique **Stainless metal**



22

Matching Design



Design **110**
Outside colour **RAL7016**
Handle **H45R-800**
Escutcheon **ESC-1**
Glazing **Clear SGC**
Applique **Stainless metal**



Design **117***
Outside colour **RAL7016**
Handle **H45R-1200**
Escutcheon **ESC-2**
Glazing **Matt SGM**
Applique **Stainless metal**

*Custom



Design **120**
Outside colour **RAL9016**
Handle **H45R-800**
Escutcheon **ESC-2**
Glazing **Tinted SGT**
Applique **Stainless metal**



Design **123**
Outside colour **RAL7016**
Handle **H45R-800**
Escutcheon **ESC-2**
Glazing **Matt SGM**
Applique **Stainless metal**

28



Design **115**
Outside colour **RAL7012**
Handle **H45R-800**
Escutcheon **ESC-2**
Glazing **Tinted SGT**
Applique **Stainless metal**



Design **117**
Outside colour **Golden Oak**
Handle **H45R-500**
Escutcheon **ESC-1**
Glazing **Clear SGC**
Applique **Stainless metal**



Design **110**
Outside colour **Old Oak**
Handle **HLA**
Glazing **Clear SGC**
Applique **Stainless metal**



Design **106**
Outside colour **RAL9016**
Handle **H45R-500**
Escutcheon **ESC-2**
Applique **Stainless metal**



Design **126***
Outside colour **RAL 9016**
Handle **H90S-1600 LED**
Escutcheon **ESC-2**
Glazing **Matt SGM**
Applique **Golden Oak**
*Custom

Features

RD67 frame is made of composite aluminium profiles with 24 mm thick thermal break. Leaf is 67 mm thick with double steel skin filled with freon free PU foam.

All windows and sidelights are triple glazed with safety glass. You can choose clear, obscure, opaque or tinted glazing options. Etched effect custom glazing available on request.



67 mm

RC 2



Thermal transmittance
U value



0.94 W/m²K*

Safety resistance class
EN 12519



RC 2

Wind resistance class
EN 12207:199-11



4

Rain resistance class
EN 12208:199-11



4A

Sound reduction
EN 717-1:2013



34,7 Db

*for 1000x2200 mm size plane leaf doors

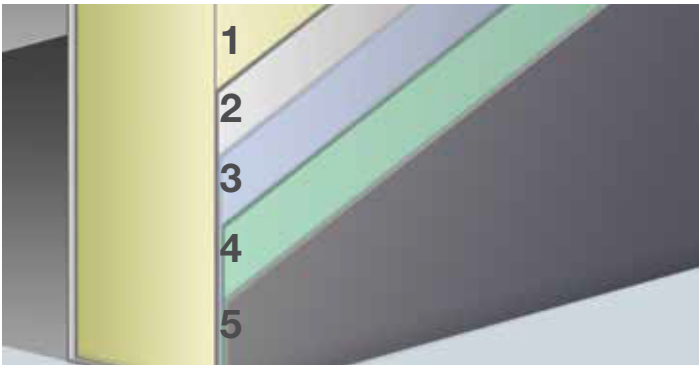

Door Leaf Structure

- 1 Polyurethane foam
- 2 Cold rolled steel
- 3 Hot dip galvanisation
- 4 Chemical treatment
- 5 Powder coated

Door Sealing

Triple rubber sealing contour provides perfect insulation. D-shape silicone rubber is not ageing or shrinking therefore door insulation does not change during a lifetime.

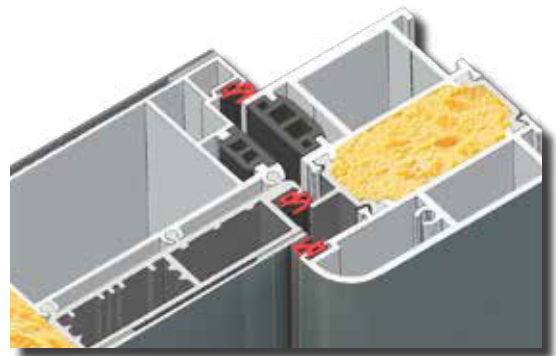

Hinges

Hinges are strong enough to support doors weighing up to 90 kg weight. Allow door to open up 180°. Hinge diameter 18 mm. Adjustable in three directions:

- Vertically +/- 3 mm;
- Horizontally +/- 3 mm;
- Sealing pressure +/- 1.0 mm.

Dr. Hahn
TÜRBÄNDER. MADE IN GERMANY.



Features

Threshold

Heavy duty durable aluminium and PVC composite threshold profile perfectly seals bottom of the door protecting your home from drafts, moisture, dust and insects.

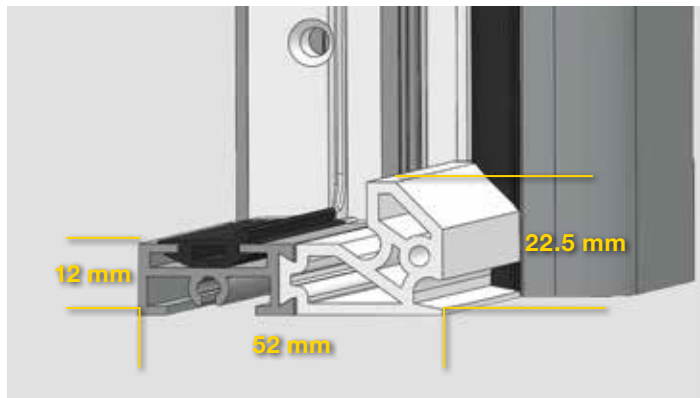

Dimensions

Threshold height is 12 mm on the inside and 22.5 mm on the outside.

Door Leaf Glazing

Triple glazed windows on door leaves. Safety glass P4A outside and inside.

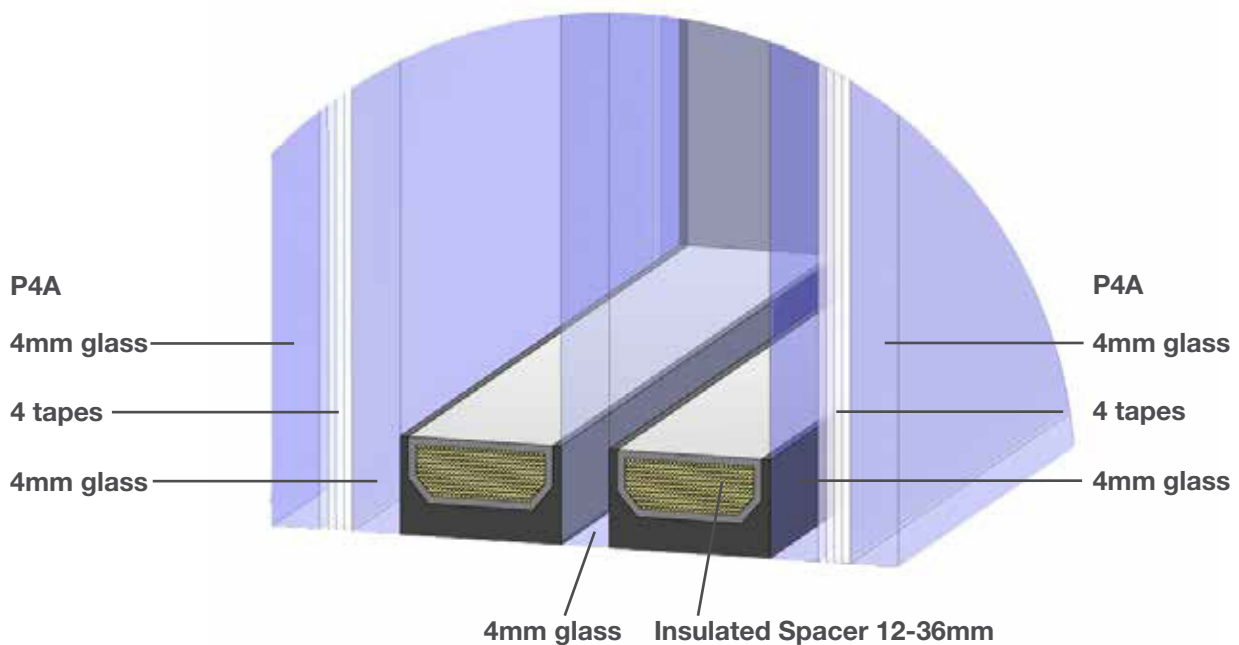

Standard RAL Colours

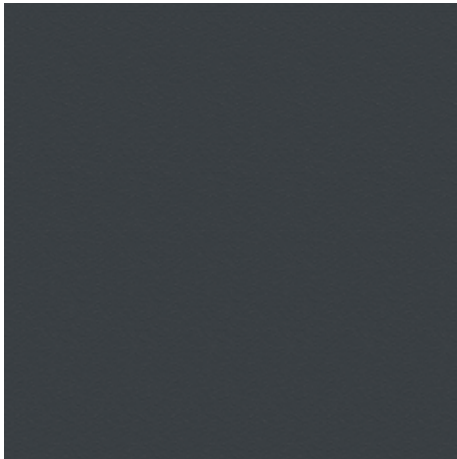

RAL 7016
Gloss 20%



RAL 7016
Structure



RAL 8017
Gloss 20%

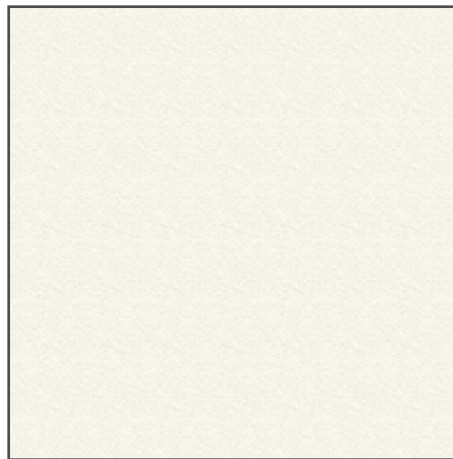

RAL 9016
Gloss 20%

Wood Images



Golden Oak



Old Oak

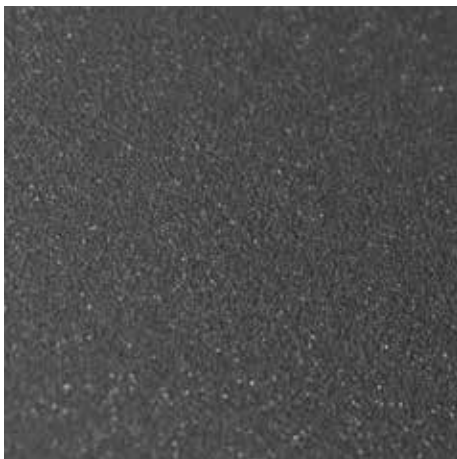

Anthracite
TG68/80043

Other RAL Colours



Structure painting available upon request

*Please note that colours depicted for guidance only. Please use official printed materials for accurate colour.

Side & Top Elements

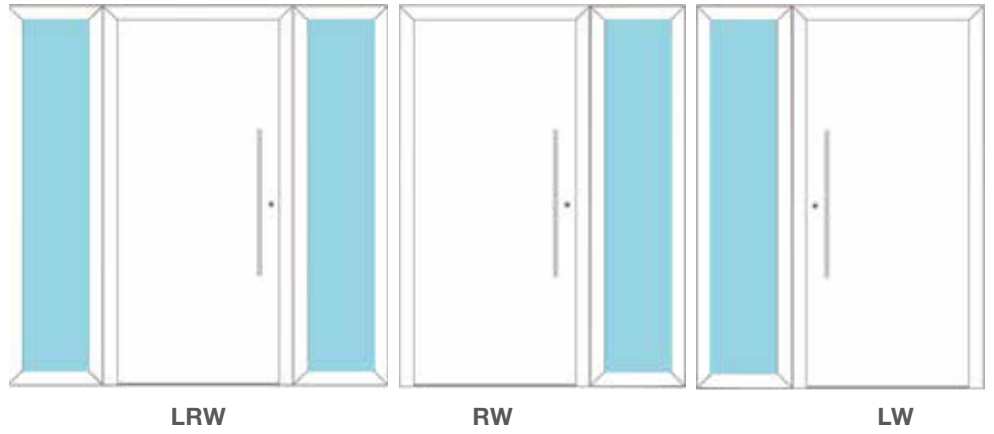
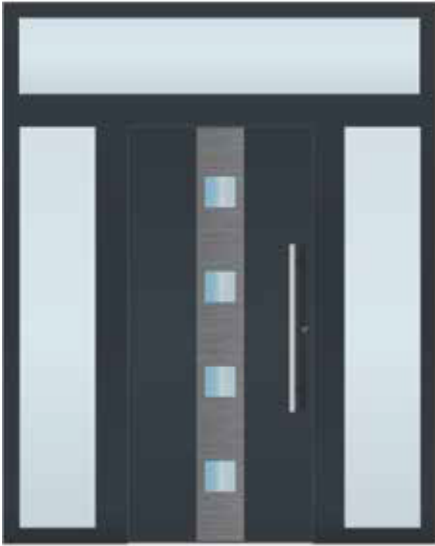

TW

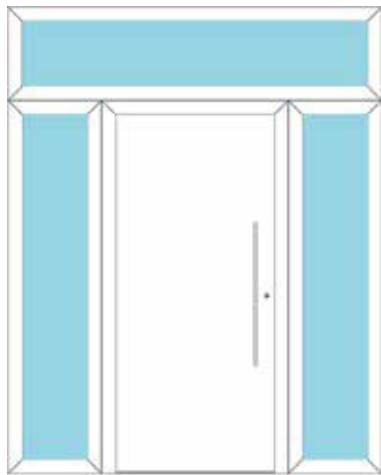

TLRW

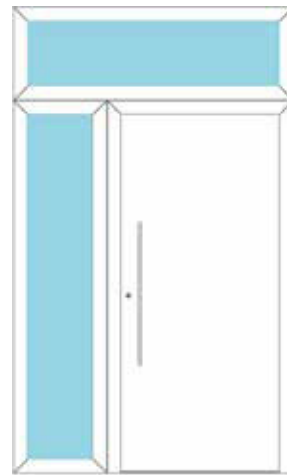

TLW

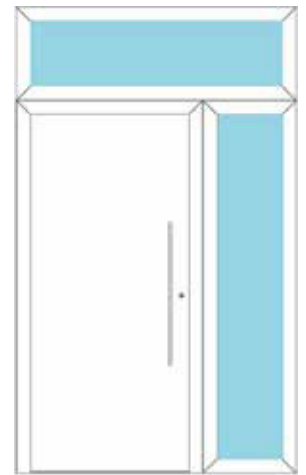

TRW

“Etched” Effect Glazing

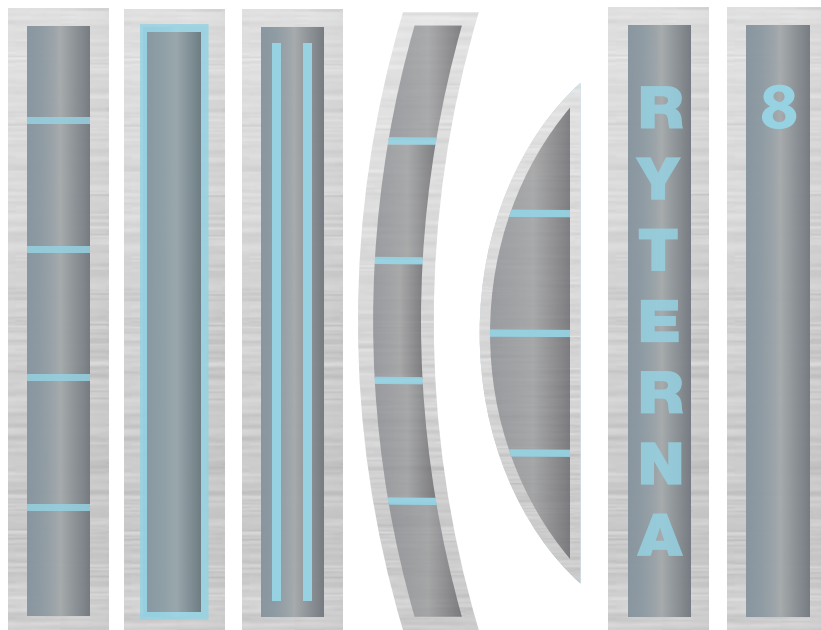

Glazing Options

STANDARD



Clear **SGC**



Matt **SGM**



Patterned **SGP**

NON-STANDARD



Similar to Delta Nr. 121



Chinchilla



Kathedral Klein



Similar to Silvit Nr. 118



Crepi

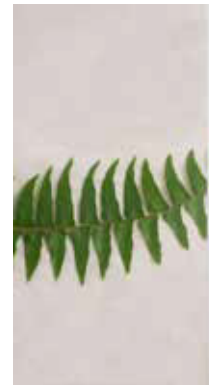

Tinted **SGT**

4mm Float + 4mm Float + 4mm Float

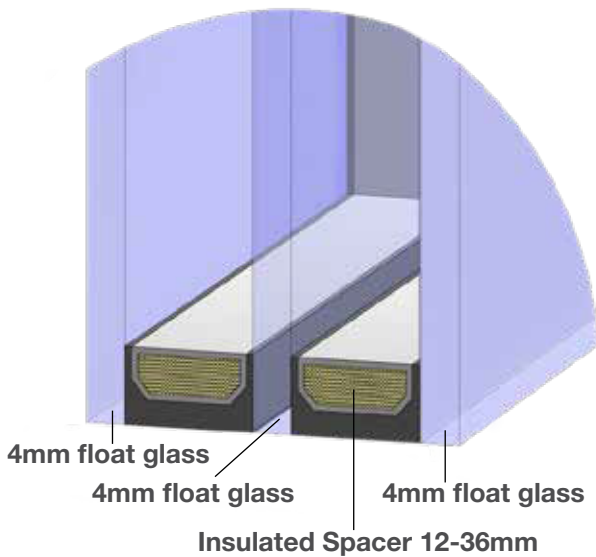

P4A + 4mm Float + P4A

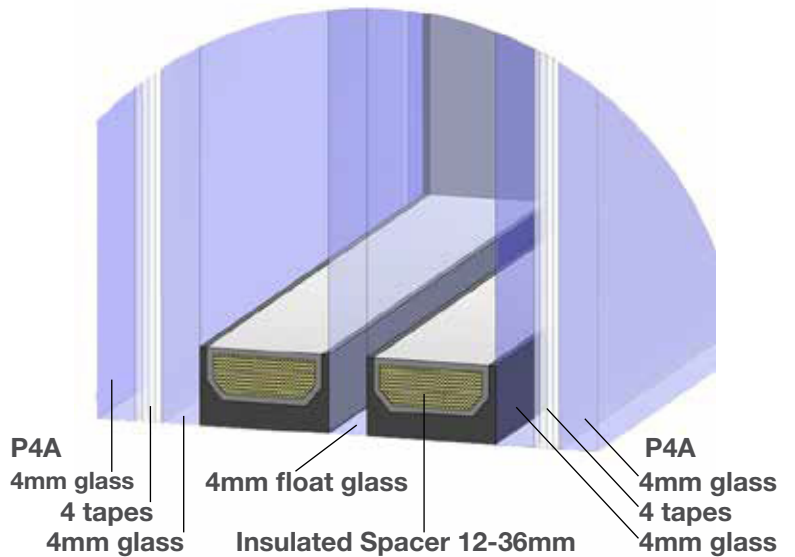

Handles

Brushed Stainless Metal Handles



H45R

Ø 30 mm
45°

Heights available:
500 mm
800 mm
1200 mm

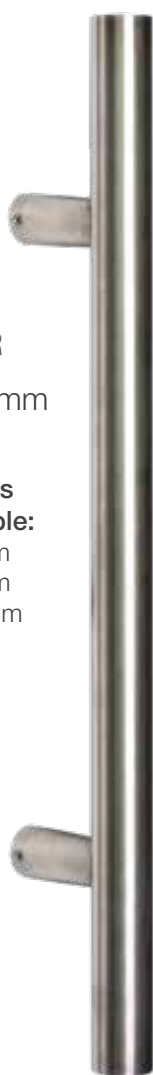

H90R

Ø 30 mm
90°

Heights available:
500 mm
800 mm
1200 mm

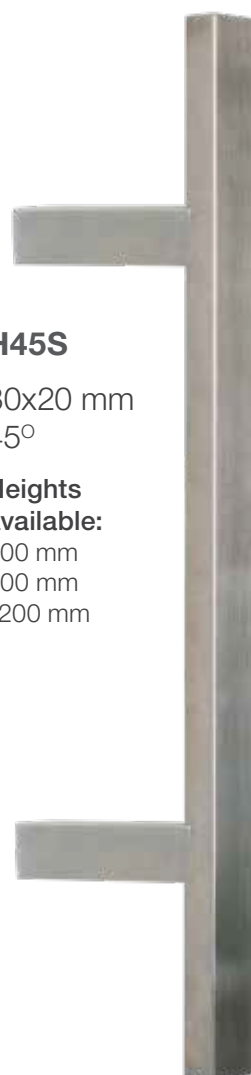

H45S

30x20 mm
45°

Heights available:
500 mm
800 mm
1200 mm

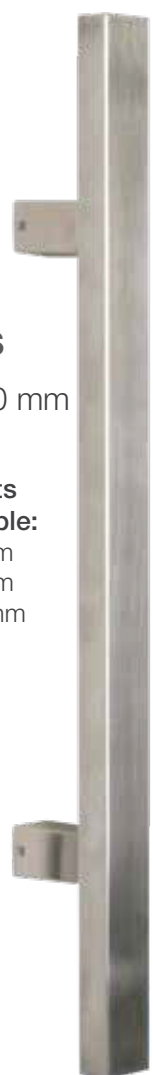

H90S

30x20 mm
90°

Heights available:
500 mm
800 mm
1200 mm

Lever And Knob Handles



HL-W (White)



HL-B (Black)



HK-W (White)*



***HK-B** (Black)



HLA



HLS 01



HLS 02



HLS 03



HLS 04



HLS 05



HLS 06



HLS 07*

*In pairs only. The rest can be fitted inside or in pairs

Escutcheons

You can choose from two stainless steel escutcheons.



ESC-1



ESC-2



CWA

CWA+TT

Lock Cylinders

WILKA lock cylinders are famous for their security and reliability. You can choose one of three safety classes: A, B or C the highest. WILKA cylinder comes with 5 keys. Additional keys are available on request.



Finger Scanners

FSC2 - can be installed on to door leaf. The finger scanner is mounted in the wall using stainless-steel accessories (in-wall set). Finger-scanner can be controlled by app. So you can open the door with your smart-phone and enjoy all the benefits of operation via app.



FSC2

FSC3 - Secure and easy to operate Sommer finger scanners. Increase key free security and convenience. Each user can enter four separate fingerprints to control your entrance door, garage door and gates. One simple swipe opens or closes your devices as desired.



FSC3

FSC4 - SIEGENIA fingerprint scanner with SI-BUS technology. Direct installation without separate control unit. With WIFI and Bluetooth chip as standard. Administration of up to 200 users or 800 features. Control via the SIEGENIA Comfort app is possible.



FSC4

Keypads

KP1 - The keypad for mounting on the wall. 3 different codes can operate 2 different relays.

KP2/KP3 - ekey Integra keypads are secure and easy to operate. Up to 99 individual users. The Keypad can be installed on door leaf or on the wall.

KP4 - SIEGENIA keypad with SI-BUS technology. Direct installation without separate control unit. With WIFI and Bluetooth chip as standard. Administration of up to 200 users or 800 features. Control via the SIEGENIA Comfort app is possible.

KP5 - ENTRAcodes+ access is secured by means of a numeric code. The code consists of 4 to 8 digits, as desired, and can be set individually.



KP1



KP2



KP3



KP4



KP5

Locks

KFV locks are made from high-quality materials with precise workmanship. Hi-tech mechanics ensure reliable, precise and easy operation. Lots of options starting from the simplest 3 point lock up to sophisticated 5 point lock.



L3P - 3 points multiple lock. Main lock deadbolt and hook bolts operated by the key.

L5P - 5 points multiple lock. Two round latch bolts lock the leaf on closure automatically and opens by the key. Deadbolt and hook bolts operated by the key.

L3P+D&N - day & night. 3 point multi-point lock with option to temporary disable self-locking. Main deadbolt and hook bolts operated by the key.

L3P+D&N+EM electric - 3 points multi-point lock with electric latch and option to temporary disable self-locking. Main lock deadbolt and hook bolts operated by the key.

L5PMA electric - 5 points multi-point lock. Round latch and hook bolts lock the leaf on closure automatically. Deadbolt operated by the key only. If deadbolt is engaged automatic unlocking is disabled. All latches open by electric drive when turning the key or pressing lever handle. Lock can be connected to finger-scanner or keypad (optional). Not compatible with lever handle from outside, pull handle only.

L5PM without electric motor - 5 points multi-point lock. Round latch and hook bolts lock the leaf on closure automatically. Deadbolt operated by the key only. All latches and deadbolt are unlocked by pressing inside handle. Not compatible with lever handle from outside, pull handle only.

L5PA electric - 5 points multi-point lock with all latches and deadbolt operated by electric drive. Locks automatically when closing the door. All latches and deadbolt open by electric drive when turning the key or pressing lever handle. Not compatible with lever handle from outside, pull handle only. Lock can be connected to finger-scanner and keypad (optional).

L5P + panic function electric - 5 points multi-point lock with all latches and deadbolt operated by electric drive. Locks automatically when closing the door. All latches and deadbolt open by electric drive when turning the key or pressing lever handle. Not compatible with lever handle from outside, pull handle only. Lock can be connected to finger-scanner and keypad (optional).



L3P



L5P

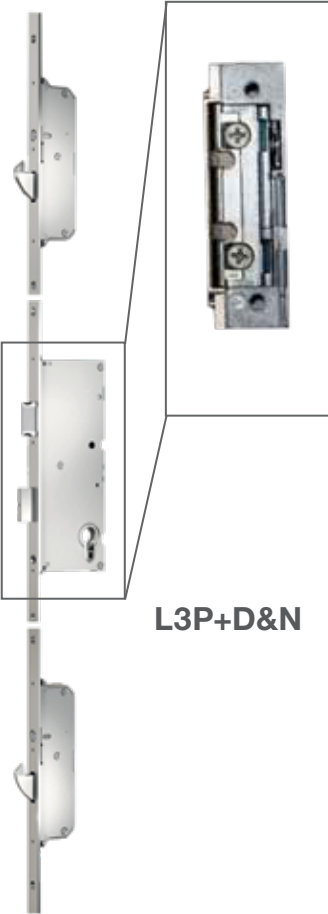

L3P+D&N



L3P+D&N+EM

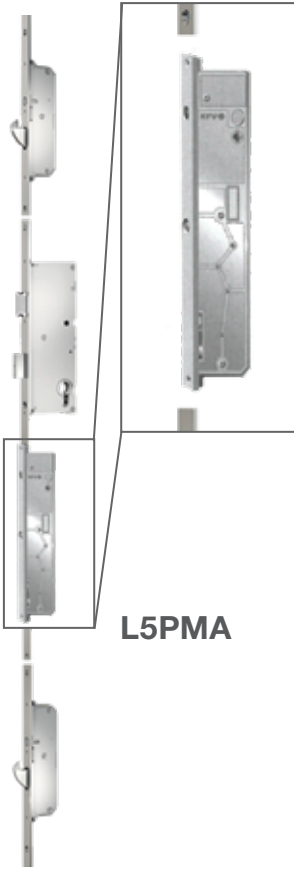

L5PMA



L5PM

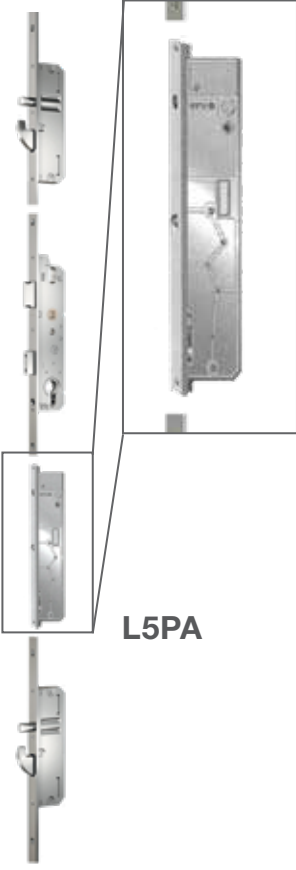

L5PA



L5P+
panic
function

Standard Designs



100



101



102



103



104



105



106



107



108



109



110



111



112



113



114



115



116



117



118



119



120



121



122



123



124



125



126



127



128



129



130



131



132



133



134



Individual Design



